

**Heavy Hex,  
Full Height**

**FLEXLOC® ALL-METAL LOCK**

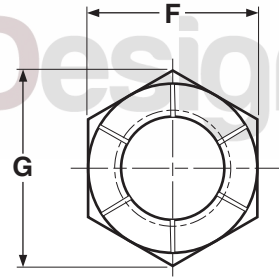
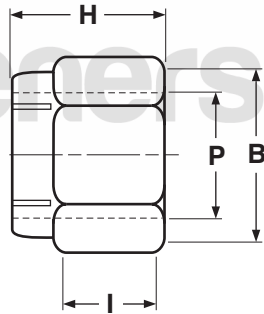

**FLEXLOC® HEAVY HEX FULL HEIGHT LOCKNUTS**

SPS

Nominal Size or Basic Thread Diameter		F		B	G	H	I	Tensile Strength for Coarse Thread Nuts—Steel & Stainless (psi.)
		Width Across Flats		Bearing Surface Outside Diam.	Width Across Corners	Thickness	Side Height	
		Max	Min	Min	Min	Max	Min	
1/4	0.2500	0.502	0.492	0.492	0.561	0.290	0.094	5,730
5/16	0.3125	0.564	0.553	0.553	0.631	0.321	0.113	9,600
3/8	0.3750	0.627	0.616	0.616	0.703	0.384	0.144	13,800
7/16	0.4375	0.752	0.741	0.741	0.846	0.446	0.163	14,900
1/2	0.5000	0.814	0.803	0.803	0.917	0.509	0.196	22,000
5/8	0.6250	1.002	0.990	0.990	1.130	0.634	0.216	34,000
3/4	0.7500	1.127	1.115	1.115	1.271	0.759	0.245	50,000
7/8	0.8750	1.314	1.301	1.301	1.484	0.884	0.397	64,600
1	1.0000	1.502	1.489	1.489	1.699	1.009	0.462	85,000
1 1/4	1.2500	2.002	1.988	1.988	2.250	1.259	0.616	125,000

<b>Description</b>	An all-metal, one-piece, hex-shaped lock nut with a round collar at its back end. The collar is segmented with opposed slots cut into it above each corner of the nut. When the screw or bolt reaches the collar, the slotted portion expands which creates the prevailing torque locking action.	
<b>Applications/Advantages</b>	The full height heavy hex lock nut has the greatest locking capability and largest wrenching area of all FlexLoc® nuts. FlexLoc nuts maintain their locking strength through 15 removals and re-applications, and at temperatures up to 550°F (450°F if zinc or cadmium plated). They have superior resistance to vibration compared to all other lock nut varieties and do not gall threads.	The full height heavy hex lock nut has the greatest locking capability and largest wrenching area of all FlexLoc® nuts. They have superior resistance to vibration compared to other stainless lock nut varieties and do not gall threads.
<b>Material</b>	<b>Steel</b> Carbon steel.	<b>Stainless</b> 18-8 Stainless
<b>Tensile Strength</b>	Minimum tensile strength requirements for carbon steel FlexLoc® nuts are listed in above table.	
<b>Plating</b>	Unless specified as plain steel, FlexLoc® nuts are used with a zinc, zinc yellow or cadmium finish.	Stainless flexible lock nuts are usually provided without any additional finish.

FLEXLOC® is a registered trademark of the SPS Technologies, Inc. Kanebridge's lock nuts are not manufactured by or connected with the producers of FLEXLOC® nuts.