

Fasteners By Design Inc.

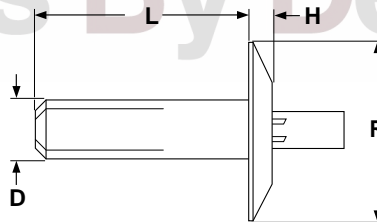

LINER HEAD DRIVE PIN RIVETS - ALL ALUMINUM

Kanebridge Part Number	Southco® Part Number	D Shank Diameter (± .001)	L Length (+.010, -.005)	Grip Range		R Head Diameter (+.005, -.010)	H Head Height (± .005)
				Min	Max		
10312ALA	10-13-706-13	.187	.484	.275	.375	.609	.085
10406ALA	10-14-706-13		.578	.375	.475		

Fasteners By Design Inc.

Description	A two-piece fastening system consisting of (1) a self-contained pin within (2) the body of a tubular-shaped rivet with a wide, trapezoidal-shaped head. The head has a very low profile and is approximately three times the diameter of the shank. The top of the rivet has an opening through which the pin protrudes. The opposite end of the rivet is enclosed but with two cross-wise slits cut into the body extending from the tip, up the shank a limited distance.
Applications/ Advantages	Drive pin rivets can join two or more pieces of low-density metal without the use of special installation tools. The rivet is inserted into pre-drilled, aligned holes and is set in place by striking the top of the pin with a hammer so that the pin is flush with the top of the head. This action causes the pin to drive through the opposite end and flare out in four directions creating a head on the blind side of the fastening. Drive pins have superior shear strength to standard break stem rivets because the pin remains inside of the installed rivet for its entire length. The liner head variety is designed specifically to be used to attach plywood or plastic liners in truck trailers.
Material	Body: Aluminum alloy 2117 H15 or equivalent alloy Pin: Aluminum alloy 2024 T4 or equivalent alloy
Shear Strength (approximate)	3/16" diameter: 650 psi. minimum
Tensile Strength (approximate)	3/16" diameter: 460 psi. minimum

Fasteners By Design Inc.